



# TECHNICAL CATALOGUE

**100 YEARS  
OF HISTORY**

# GEALAN INNOVATION MIT SYSTEMS

Our inspiration - to fascinate people!

With the most innovative window systems, surfaces and best in class digital solutions, we set the main trends and form the framework for the world of windows.

The GEALAN group is one of Europe's leading manufacturers of vinyl profiles for windows and doors.

The core components of the GEALAN brand include modern profile systems such as 39, 44, 60 and 64 mm series profiles for both sliding and casement series of profiles. Intensive core insulation and colour with various wood-grain foiling windows.

As an innovative system provider for vinyl window and door profiles, GEALAN also offers its partner companies comprehensive services in the areas of marketing and advertising, architectural consultation and training for window manufacturers and architects.



# PRIMA CASEMENT



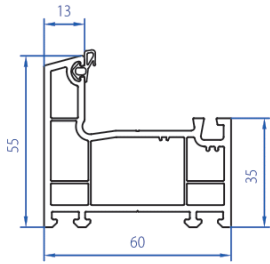

Casement Frame  
2101-1101

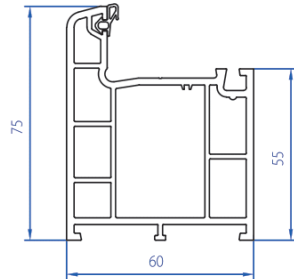

Door Frame  
2101-1103

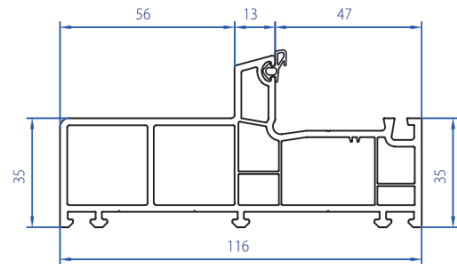

Frame with Grill & Mesh  
2101-1102

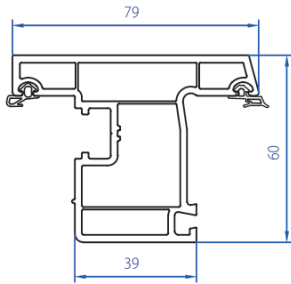

Outward Window Sash  
2103-1101

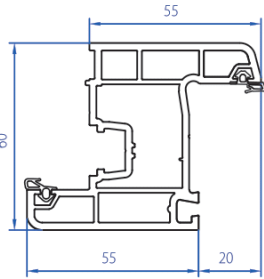

Inward Window Sash  
2103-1103

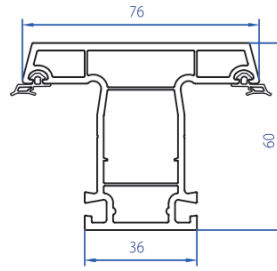

T-Mullion  
2102-1101

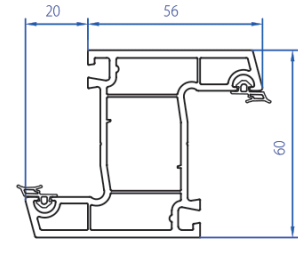

Z-Mullion  
2102-1102

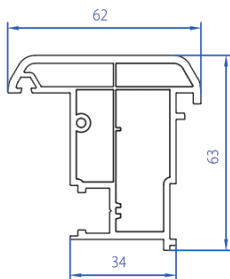

French Mullion  
2102-1103

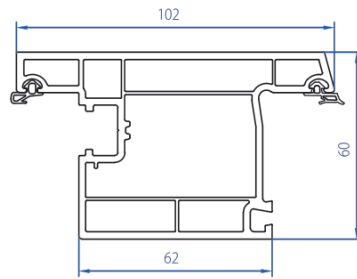

Outward Door Sash  
2103-1102

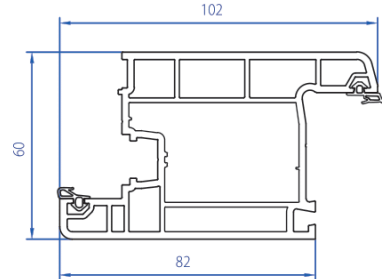

Inward Door Sash  
2103-1104

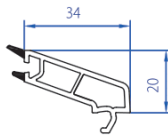

Casement Glazing Bead  
(5-6mm)  
2107-4103

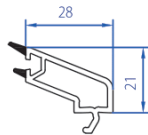

Casement Glazing Bead  
(12mm)  
2107-4104

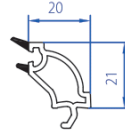

Casement Glazing Bead  
(20mm)  
2107-4105

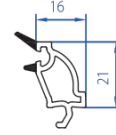

Casement Glazing Bead  
(24mm)  
2107-4106

# PROFILES

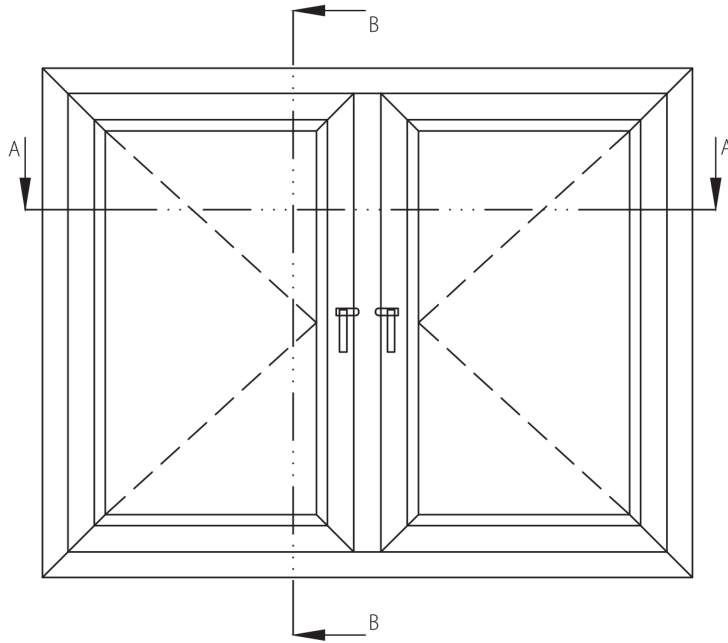

2101-1101  
9201-1504  
  
9203-1501  
2103-1101  
2107-4103

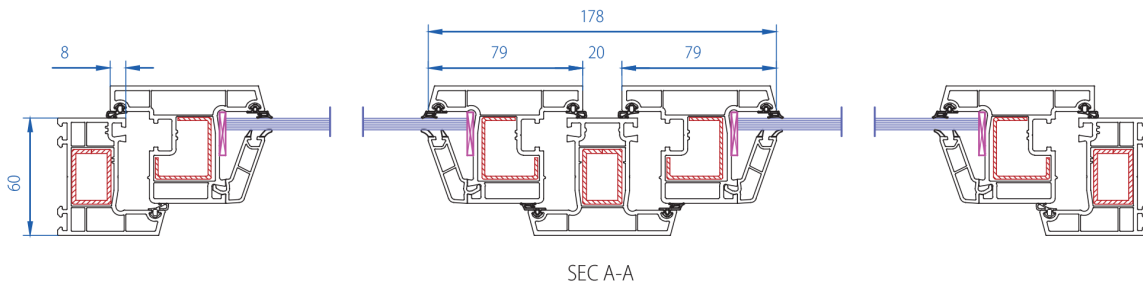
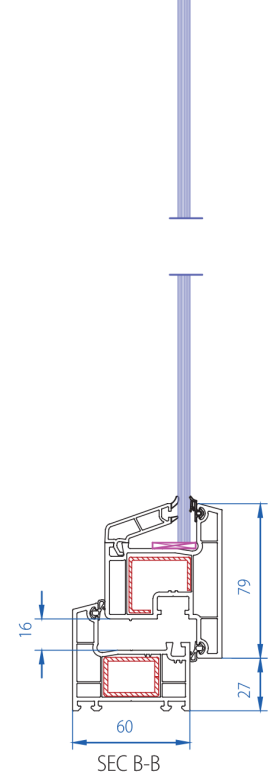
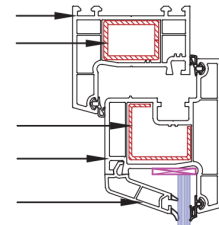

# DOUBLE SASH CASEMENT WINDOW SECTIONAL DRAWING

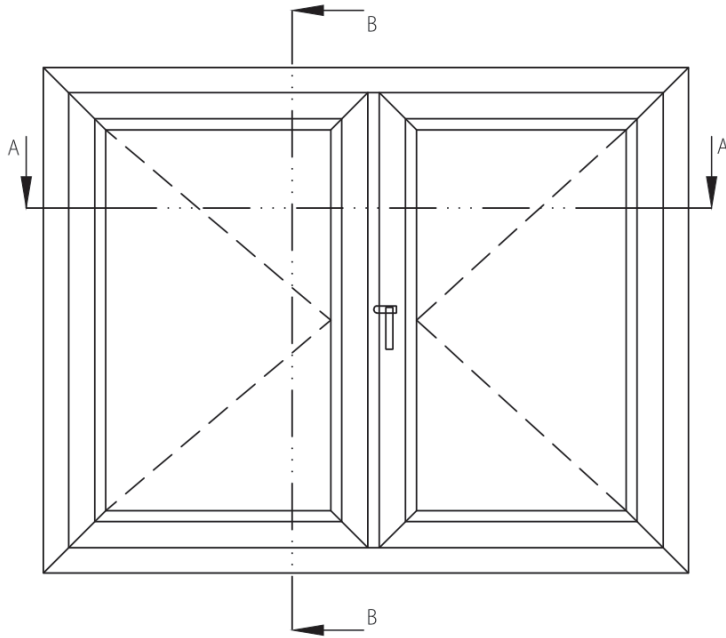

2101-1101  
9201-1504

9203-1501  
2103-1101  
2107-4103

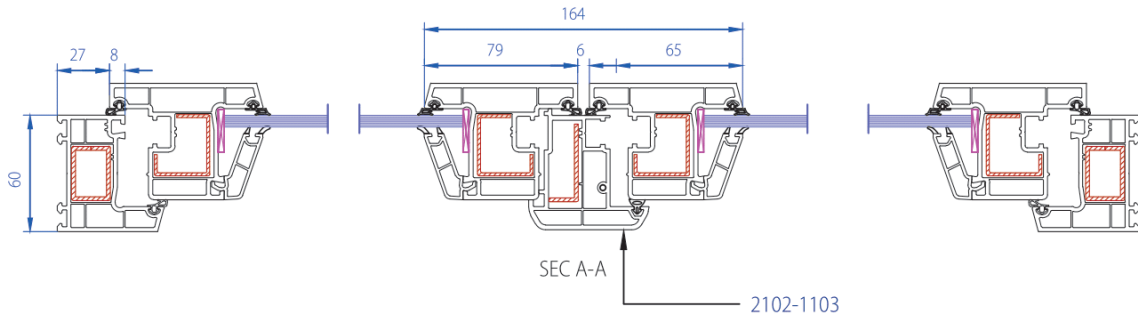
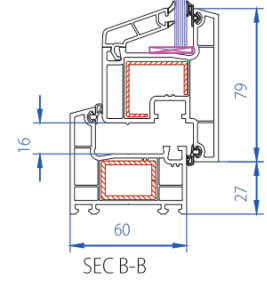
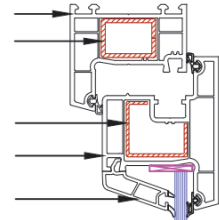

2102-1103

# FRENCH WINDOW SECTIONAL DRAWING

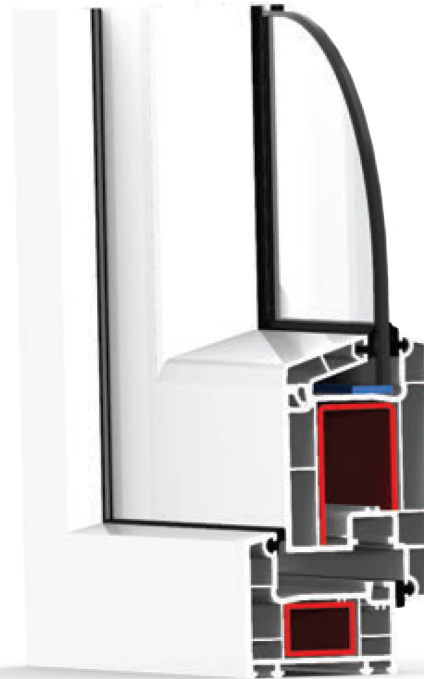

# PRIMA CASEMENT

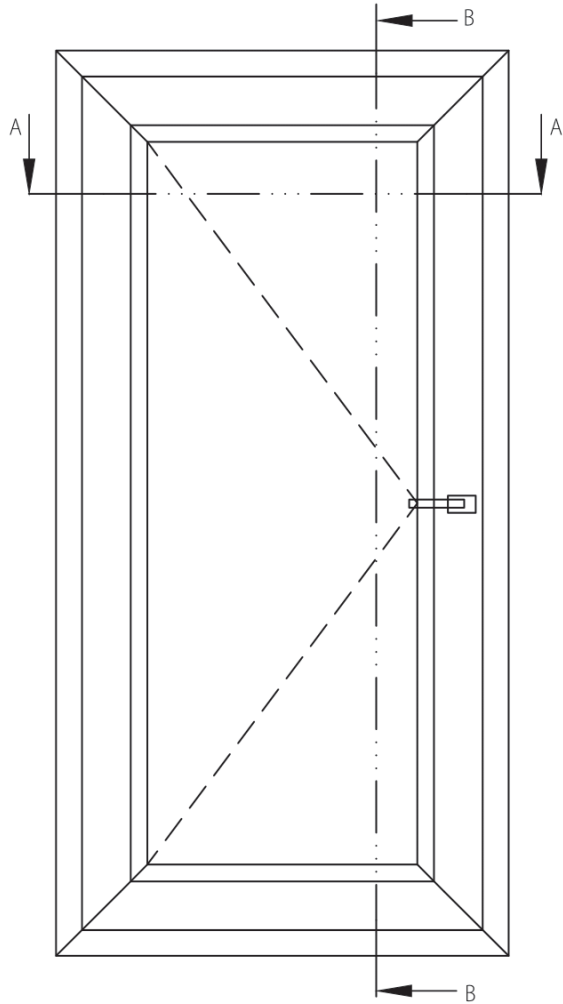

- 2101-1101
- 9201-1504
- 9203-1502
- 2103-1102
- 2107-4103

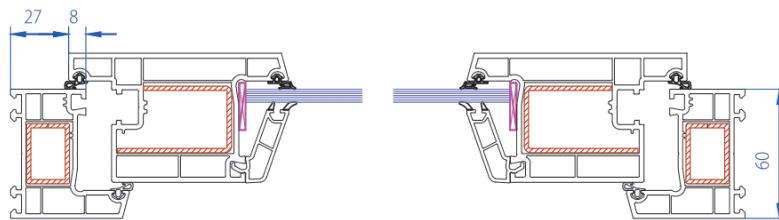
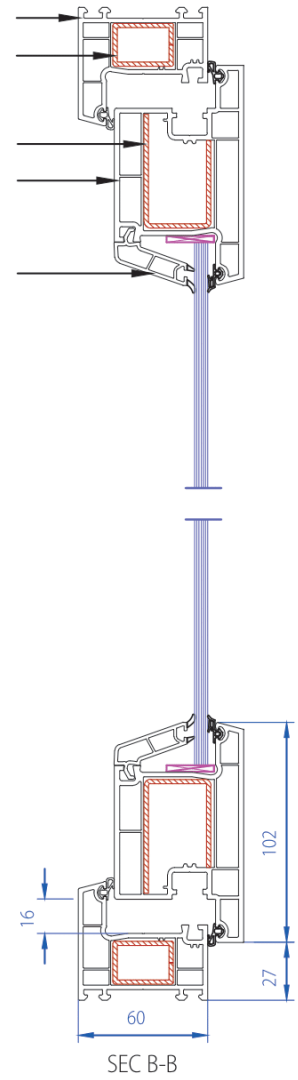

# CASEMENT DOOR SECTIONAL DRAWING

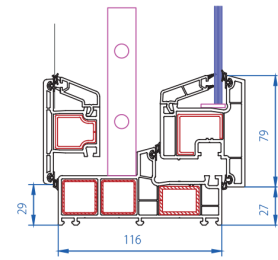
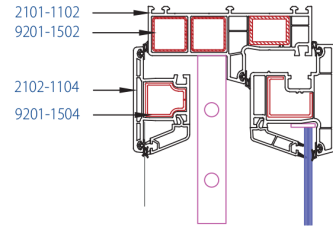
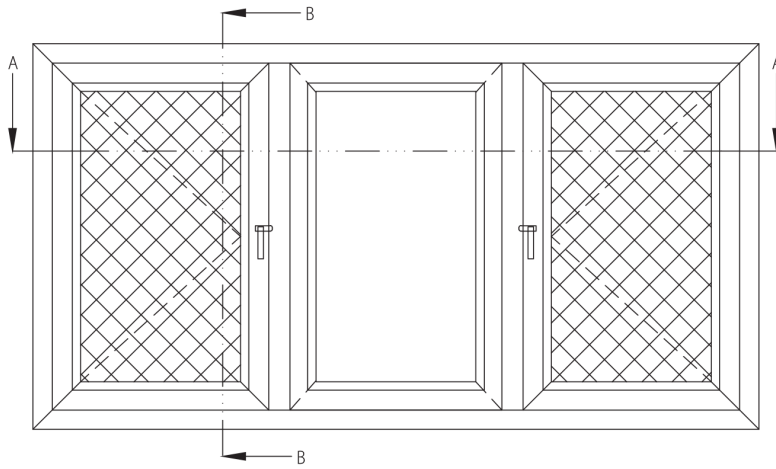

SEC B-B

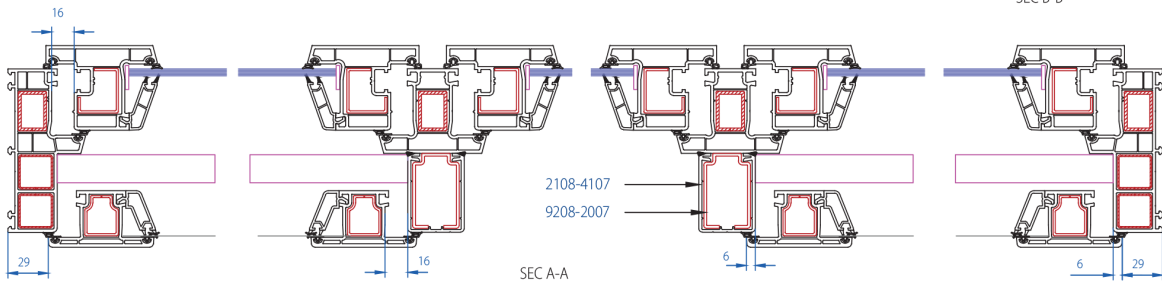

SEC A-A

# TWIN SASH CASEMENT WINDOW WITH MESH AND GRILL SECTIONAL DRAWING

90° Corner Coupling  
2108-3101

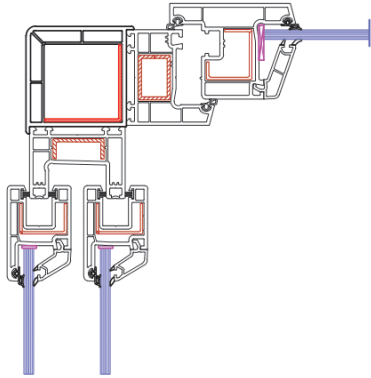

90° Corner Coupling  
2108-3101

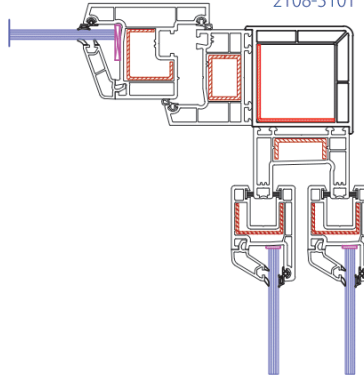

135° Corner Coupling  
2108-3110

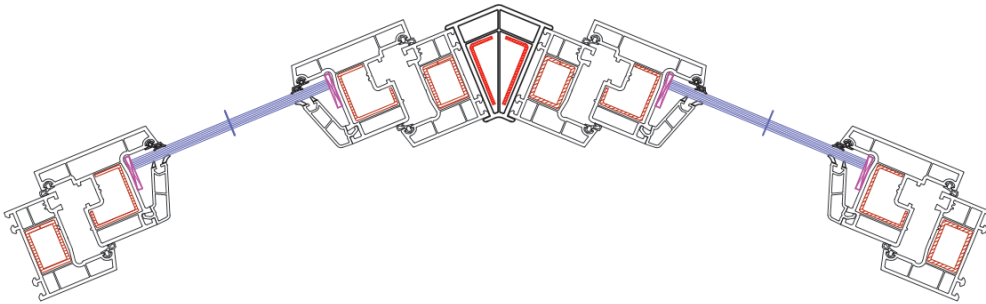

Bay Pole Adaptor  
2108-3104  
Bay Pole  
2108-3103

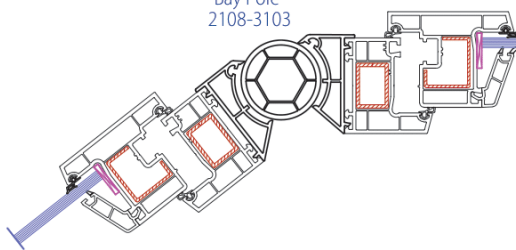

Bay Pole Adaptor  
2108-3104  
Bay Pole  
2108-3103

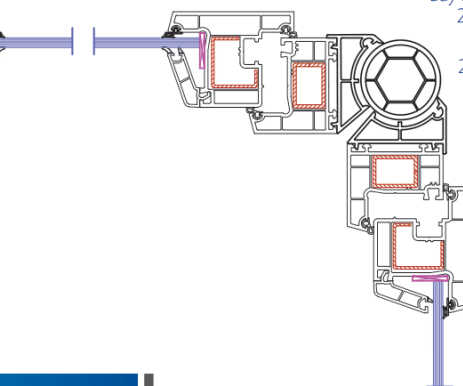

## ANCILLARY PROFILES COUPLING JOINERY

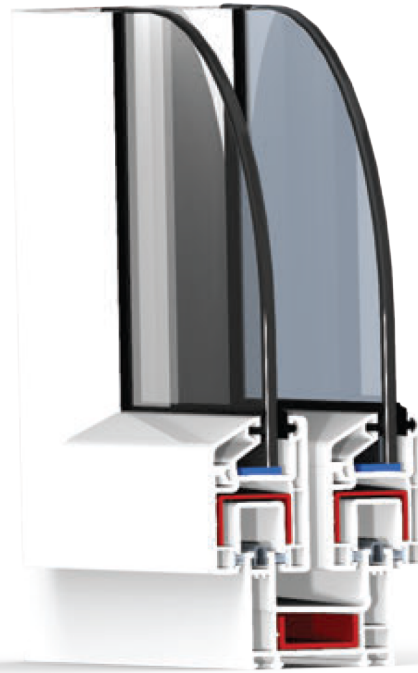

**PRIMA**  
**SLIDING**



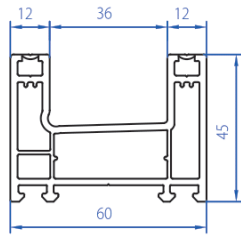

2T Sliding Frame  
2104-3101

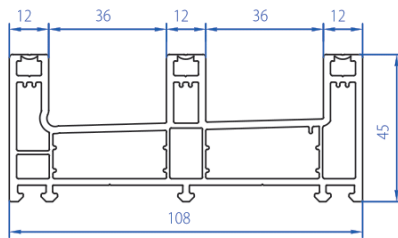

3T Sliding Frame  
2104-3102

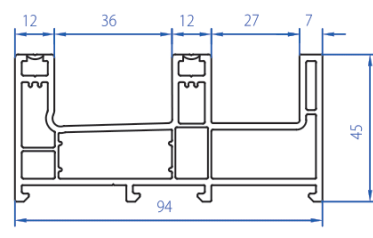

Sliding Frame with Mesh  
2104-3103

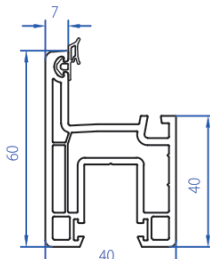

Sliding Window Sash  
(Non-Euro groove)  
2105-1101

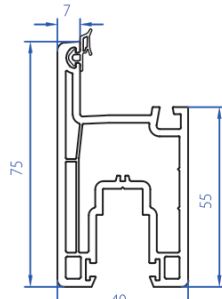

Sliding Sash  
2105-1102

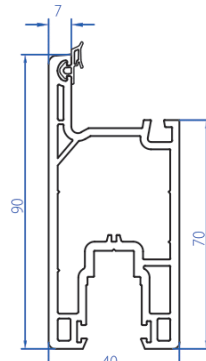

Sliding Door sash  
2105-1103

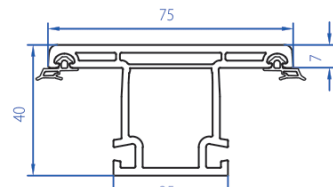

Sliding Mullion  
2102-1104

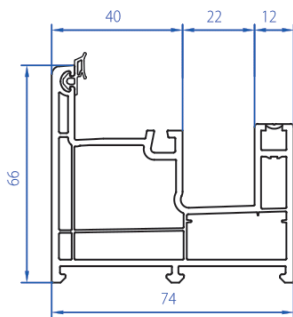

Monorail Sliding Frame  
2104-1104

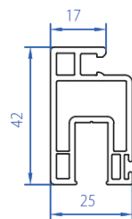

Fly Mesh Sash (Small)  
2105-3104

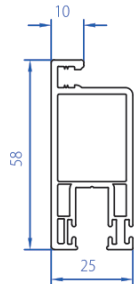

Fly Mesh Sash (Big)  
2105-3105

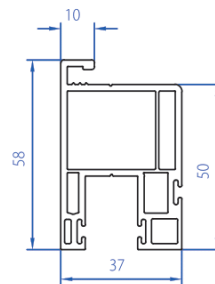

Fly Mesh Sash  
(For 3 Track)  
2105-3106

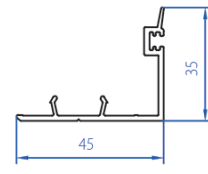

Sliding Window Interlock  
2106-3101

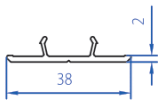

Cover Profile  
2106-3102

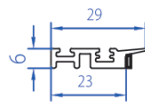

Interlock Profile  
2106-4103

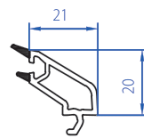

Sliding Single Glazing  
Bead (5-6mm)  
2107-4101

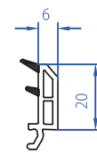

Sliding Double Glazing  
Bead (21-22mm)  
2107-4102

# PROFILES

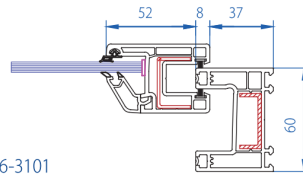
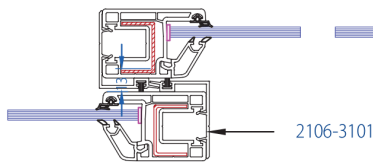
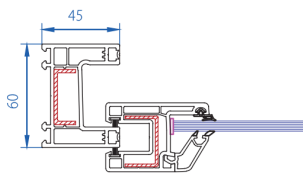
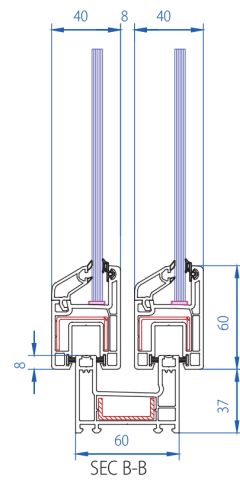
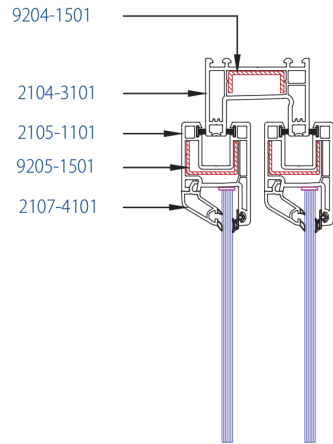
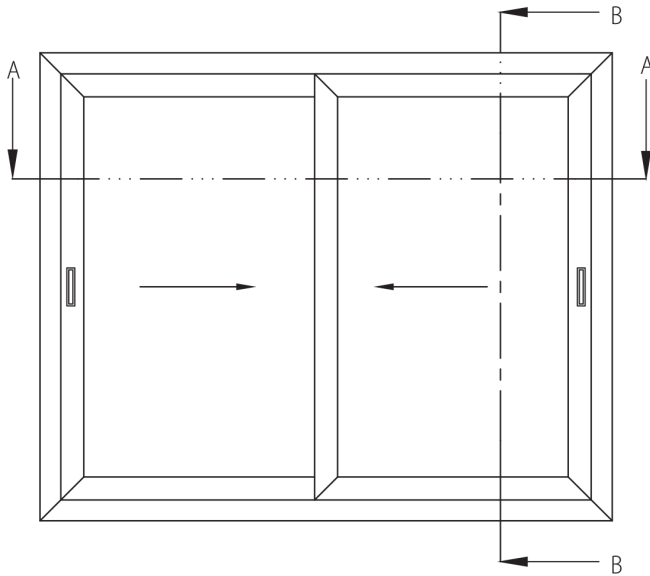

SEC A-A

# 2 TRACK 2 PANEL WINDOW SECTIONAL DRAWING

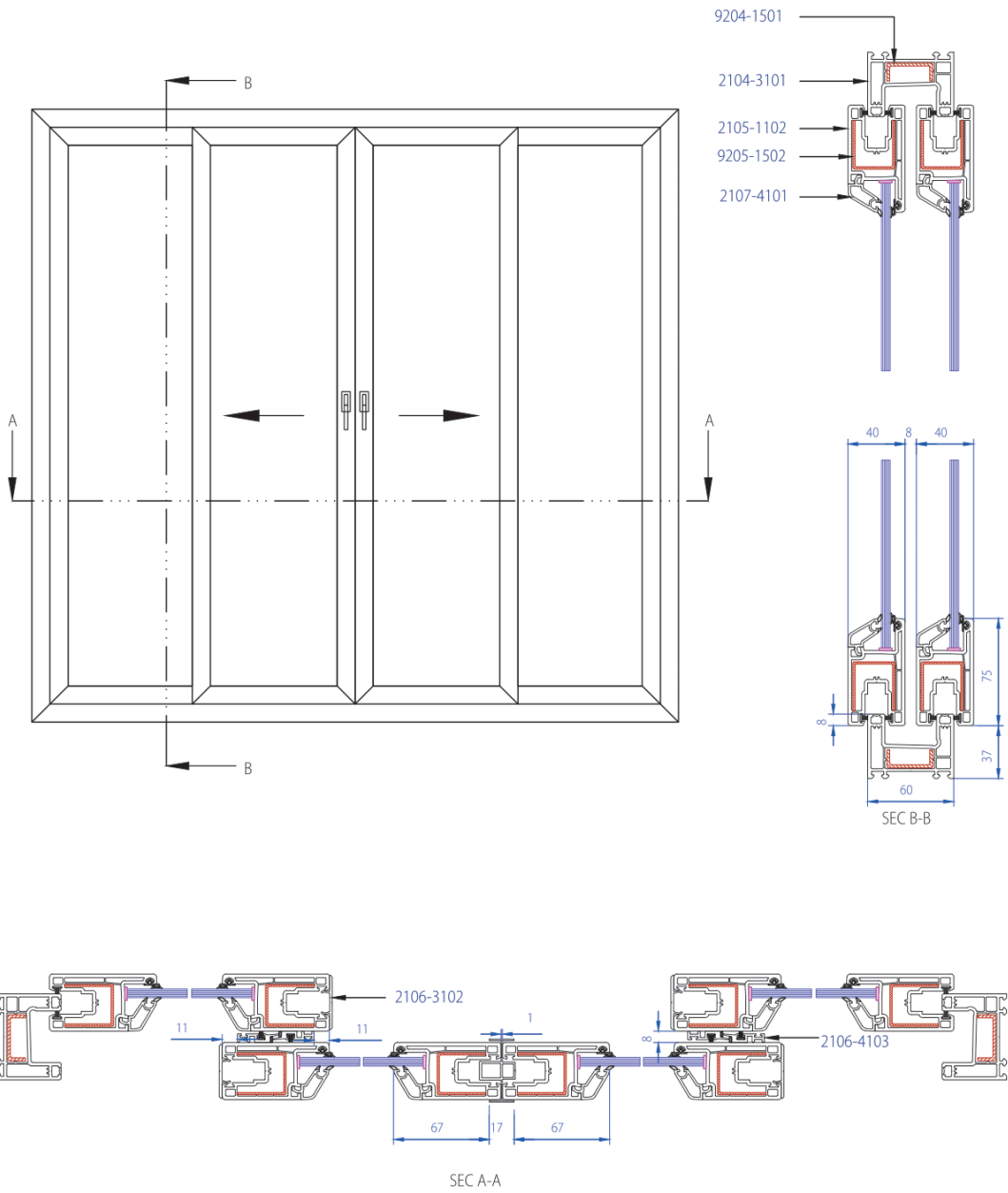

# 2 TRACK 4 PANEL DOOR SECTIONAL DRAWING

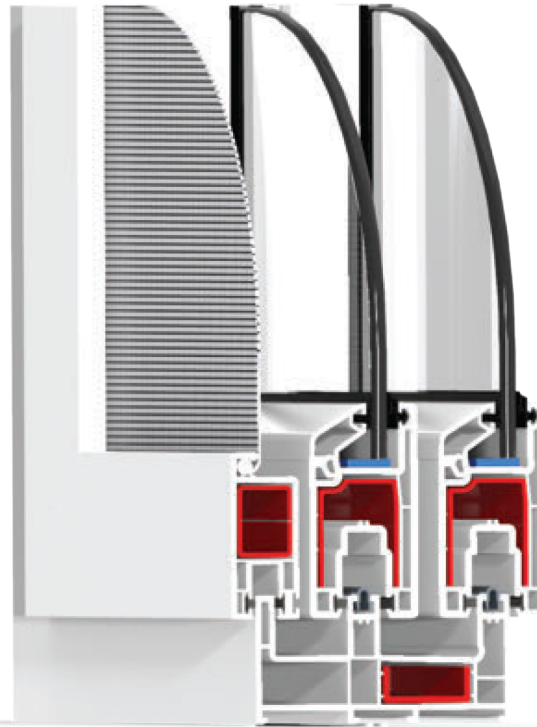

**PRIMA**  
**SLIDING**

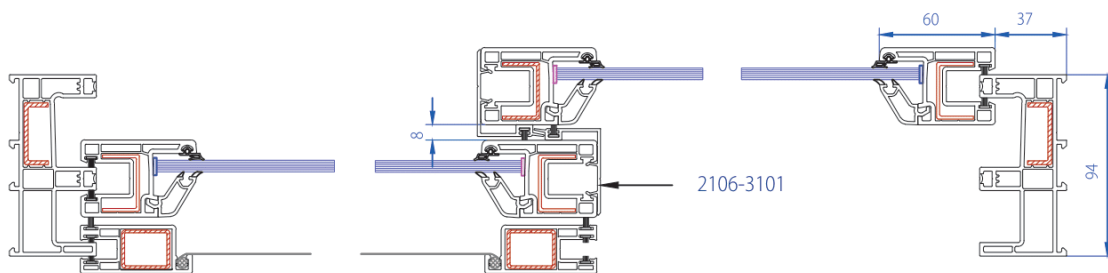
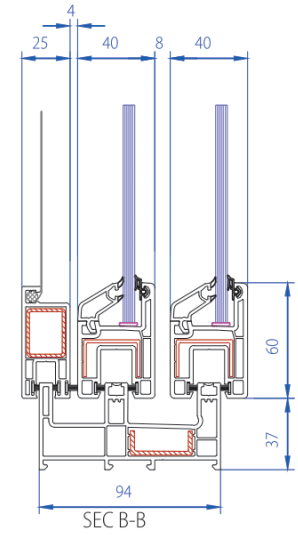
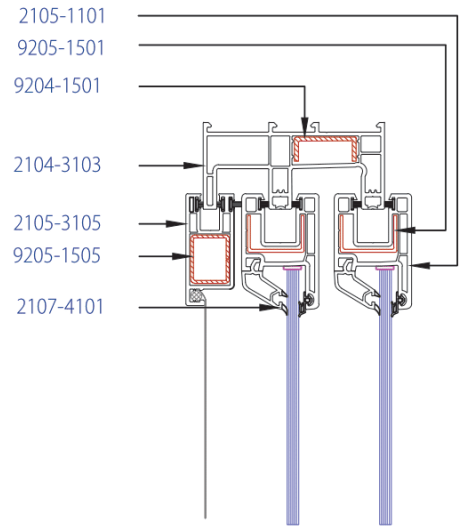
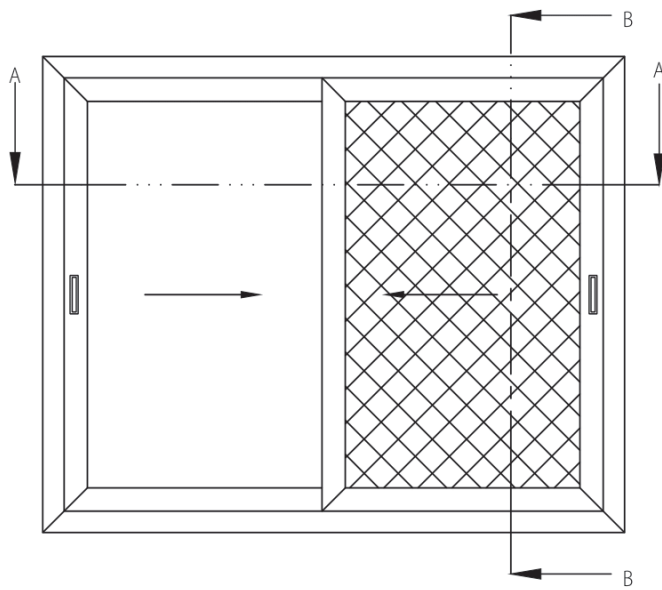

SEC A-A

# 2.5 TRACK 2 PANEL AND MESH SECTIONAL DRAWING

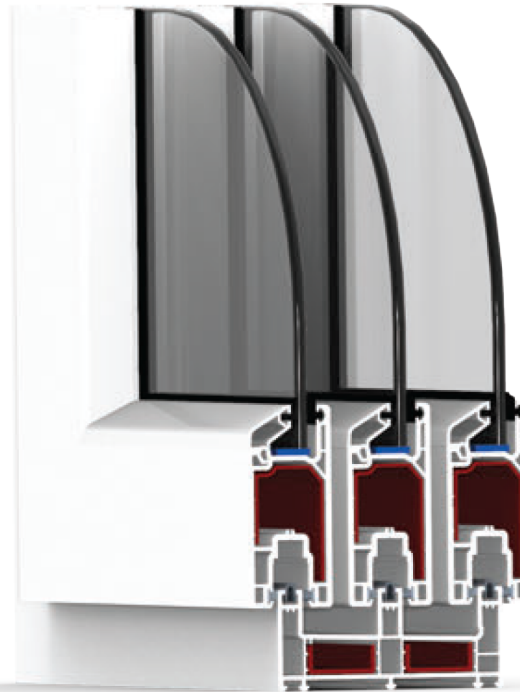

**PRIMA**  
**SLIDING**

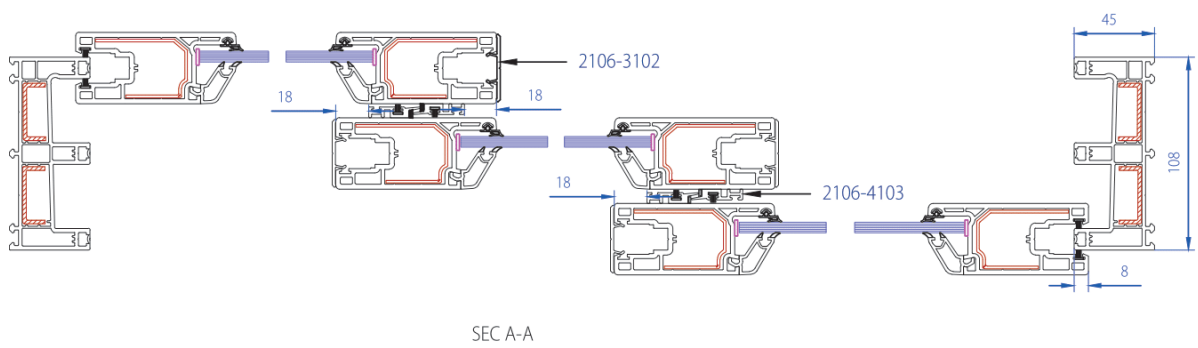
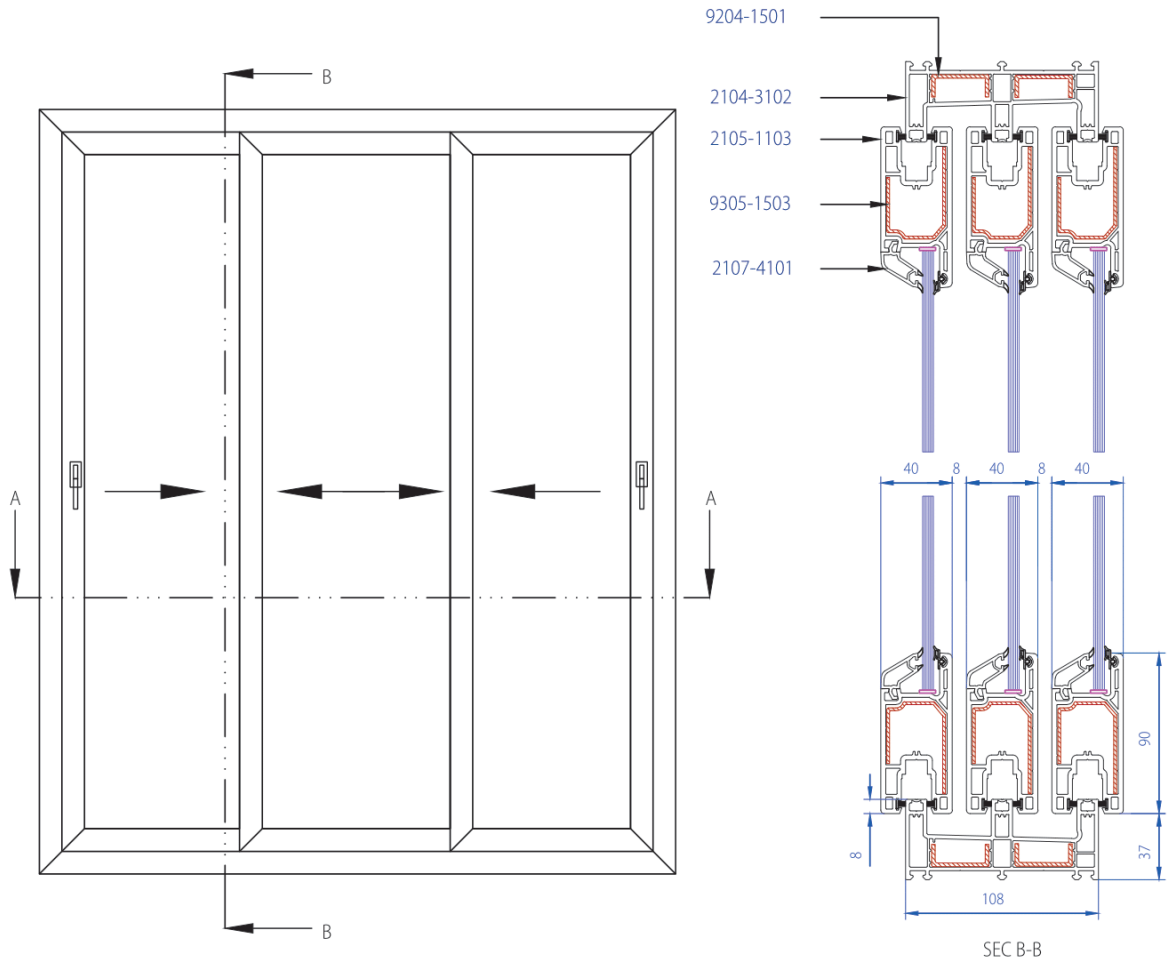

# 3 TRACK 3 PANEL DOOR SECTIONAL DRAWING



**SUPRA**  
**SLIDING**



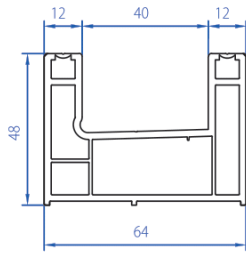

2T Sliding Frame  
3104-3101

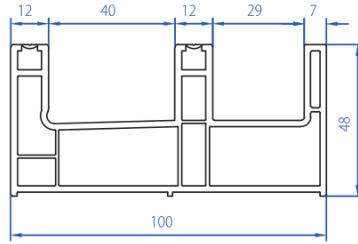

Sliding Frame with Mesh  
3104-3103

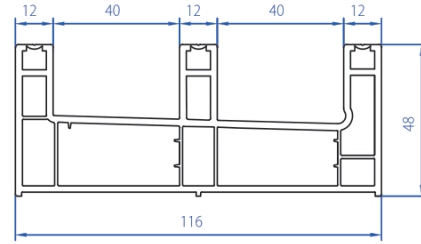

3T Sliding Frame  
3104-3102

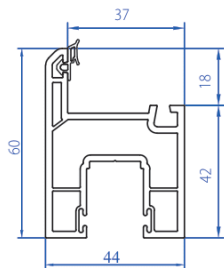

Sliding Window Sash  
(Non-Euro groove)  
3105-1101

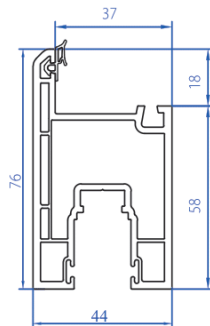

Sliding Sash  
3105-1102

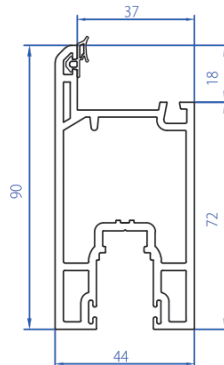

Sliding Door sash  
3105-1103

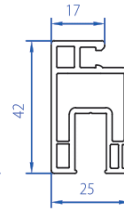

Fly Mesh Sash (Small)  
2105-3104

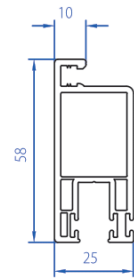

Fly Mesh Sash (Big)  
2105-3105

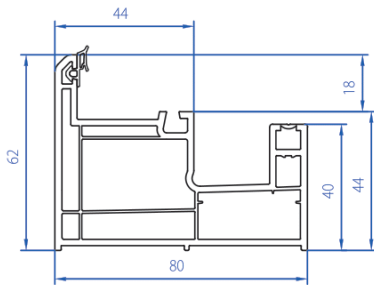

Monorail Sliding Frame  
3104-1104

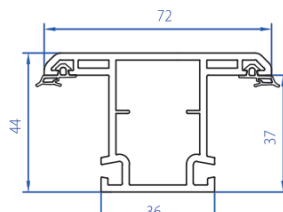

Sliding Mullion  
3102-1104

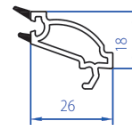

Sliding Glazing Bead  
(5-6mm)  
3107-4101



Double Glazing Bead  
(24mm)  
3107-4102

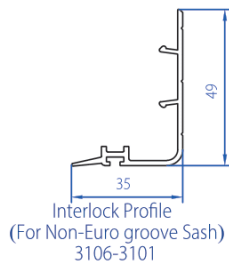

Interlock Profile  
(For Non-Euro groove Sash)  
3106-3101

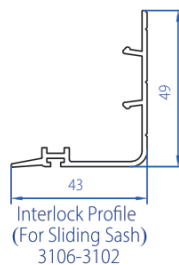

Interlock Profile  
(For Sliding Sash)  
3106-3102

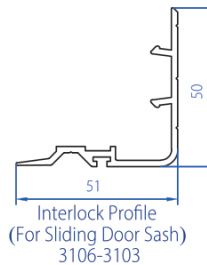

Interlock Profile  
(For Sliding Door Sash)  
3106-3103

# PROFILES

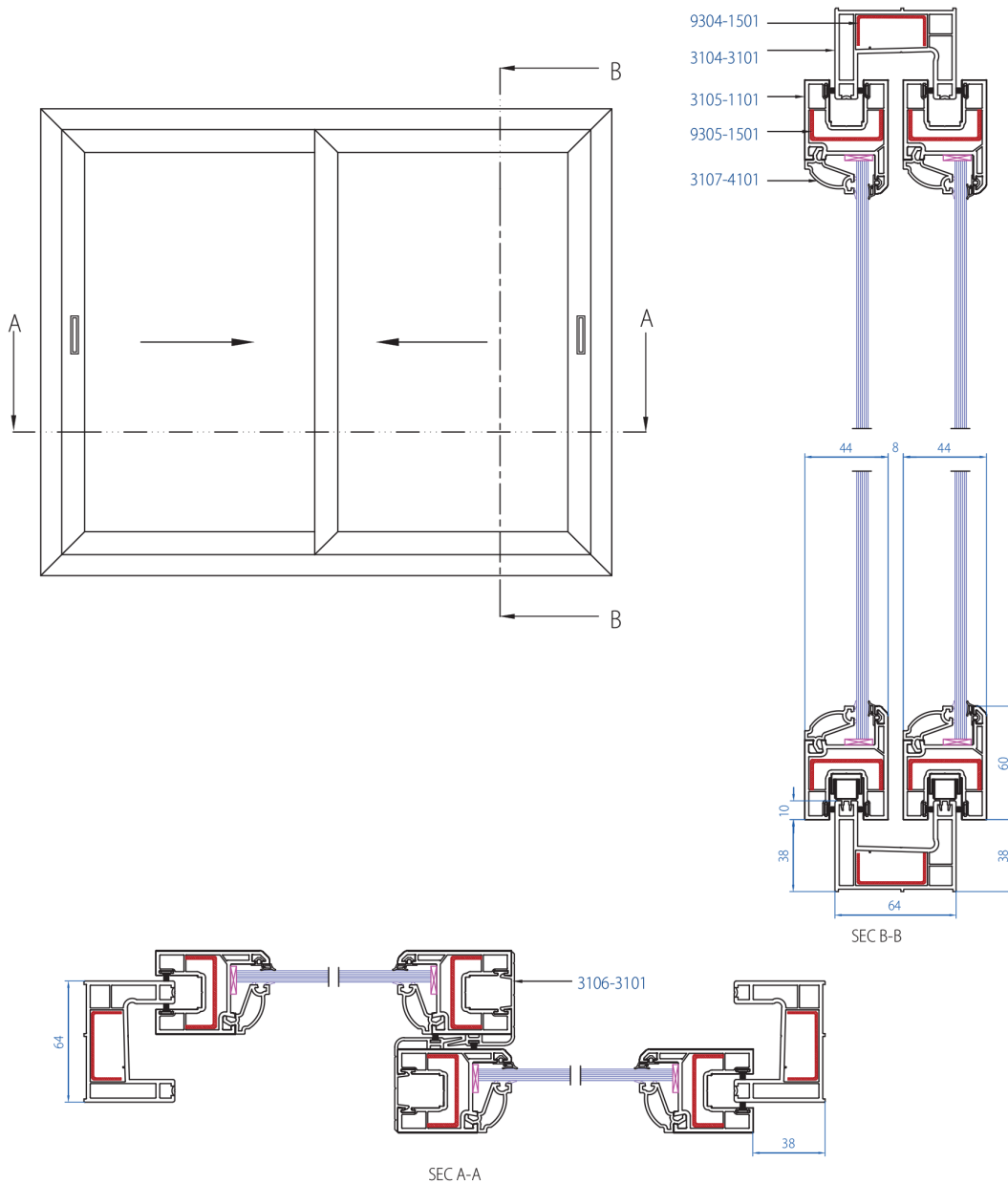

## 2 TRACK 2 PANEL WINDOW SECTIONAL DRAWING

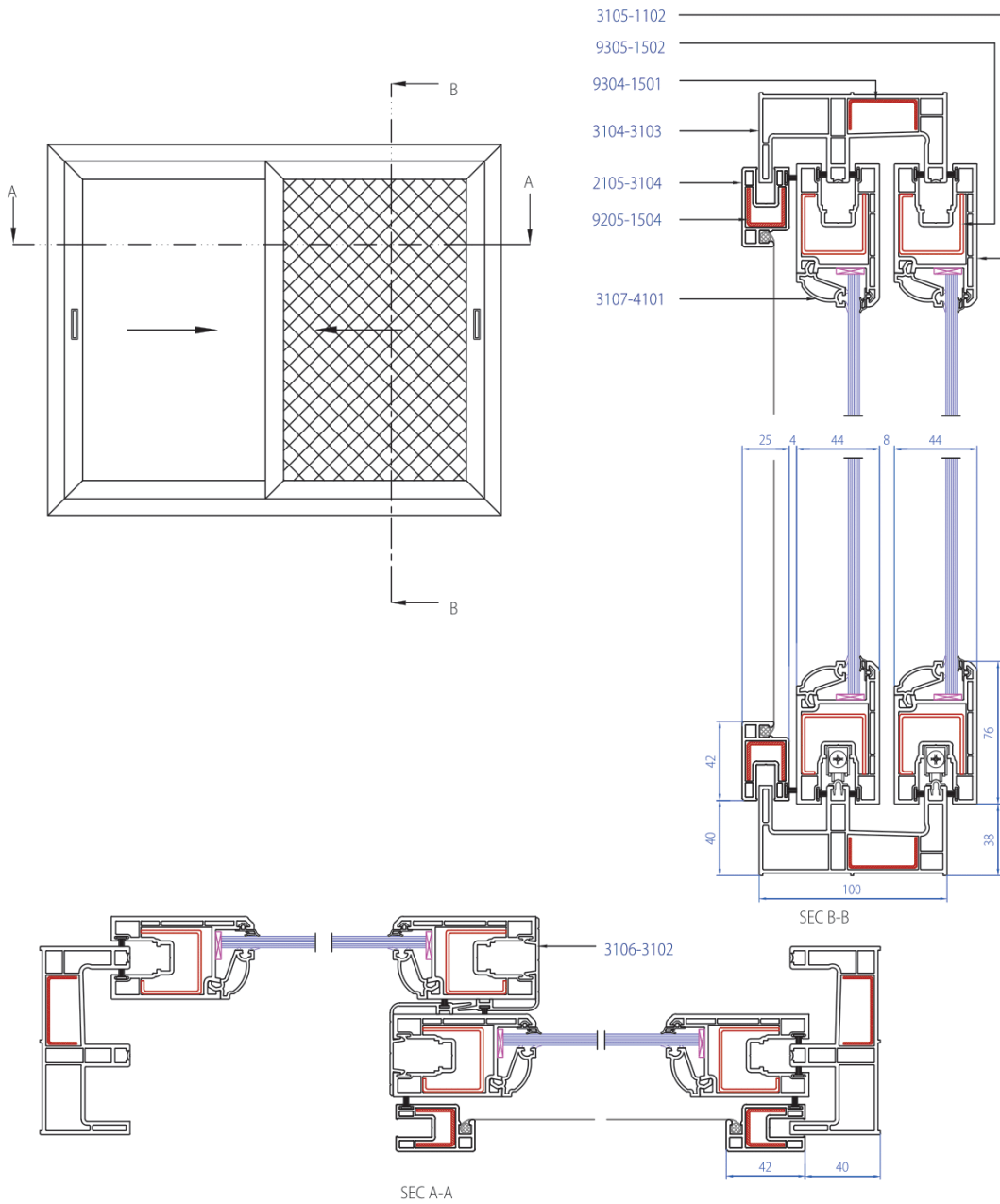

## 2.5 TRACK 2 PANEL AND MESH SECTIONAL DRAWING

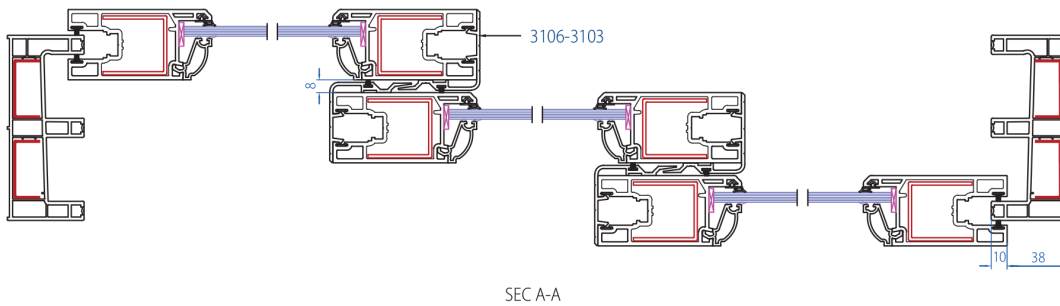
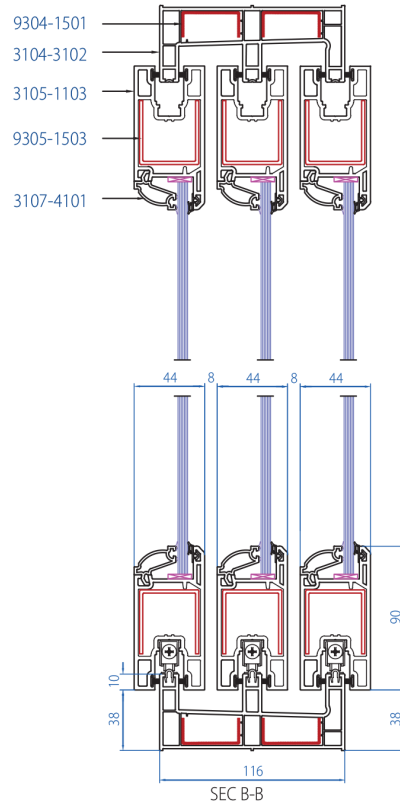
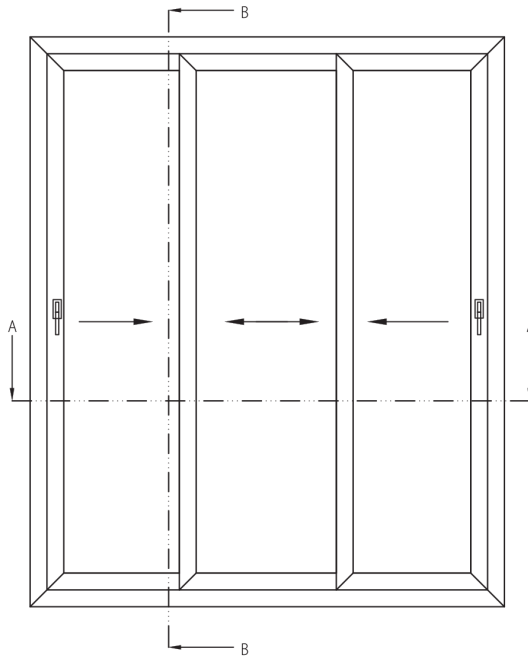

## 3 TRACK 3 PANEL DOOR SECTIONAL DRAWING

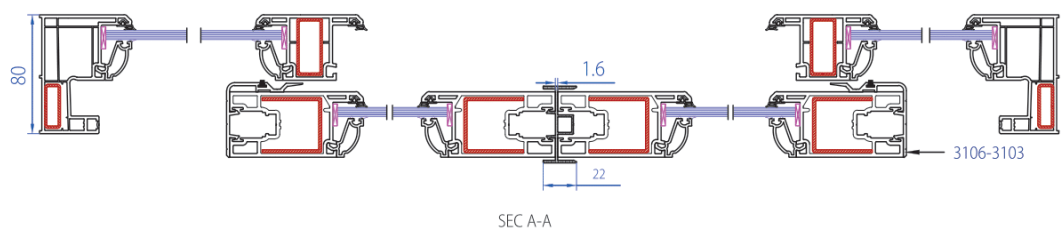
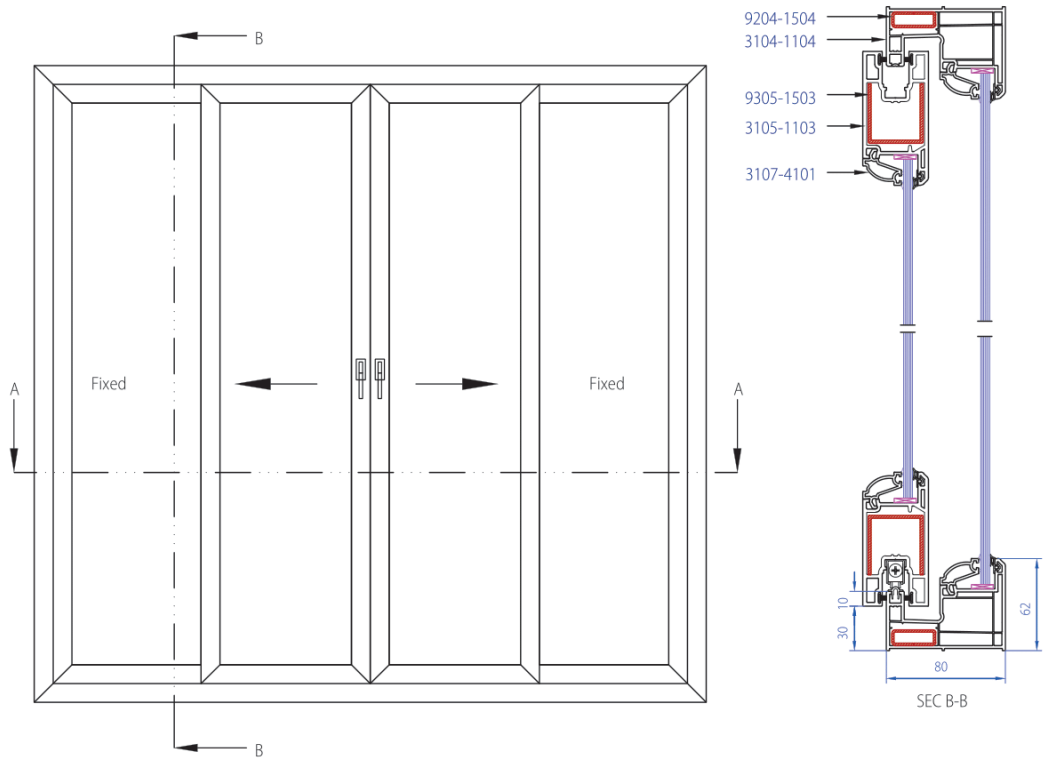

# 2 TRACK 4 PANEL DOOR SECTIONAL DRAWING

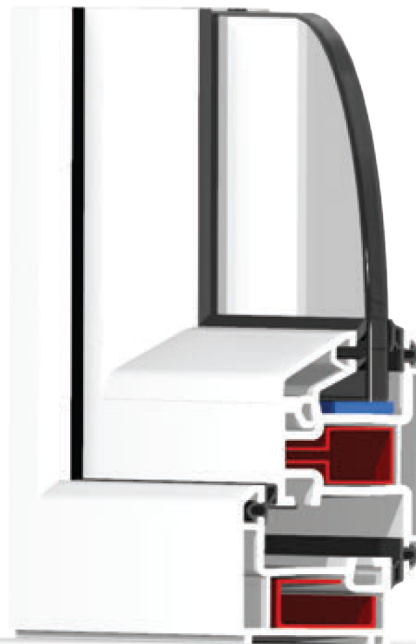

# SELECTA CASEMENT

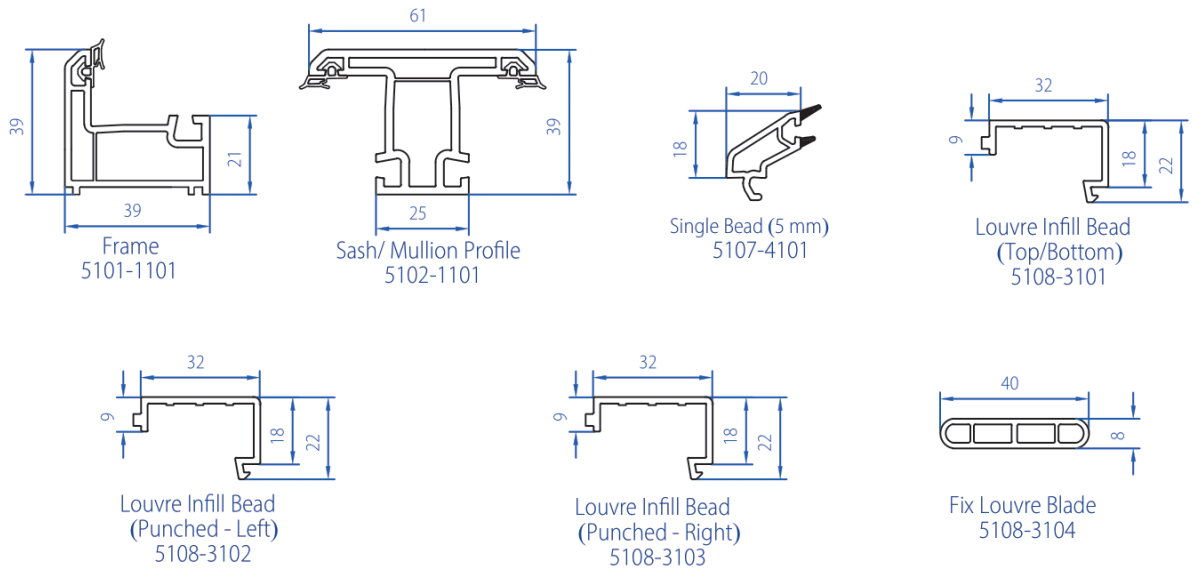

# PROFILES

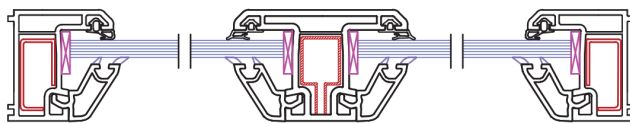
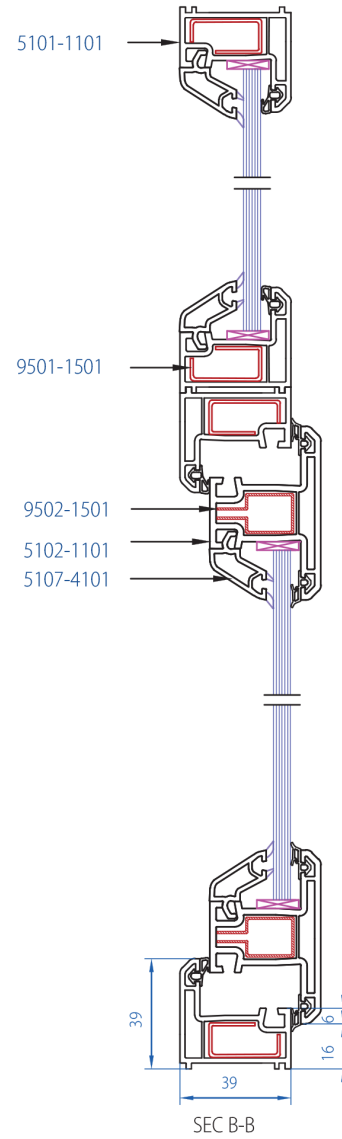
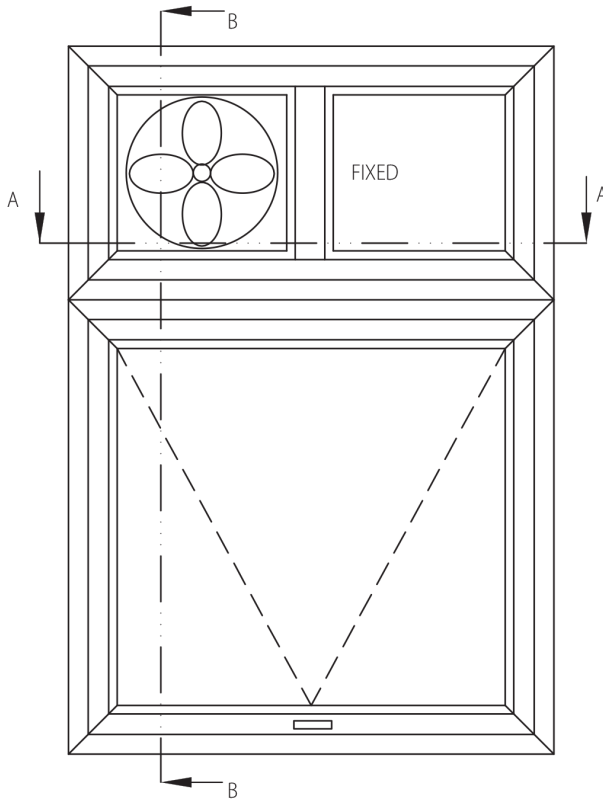

SEC A-A

SEC B-B

# TOP HUNG WITH VENTILATOR SECTIONAL DRAWING



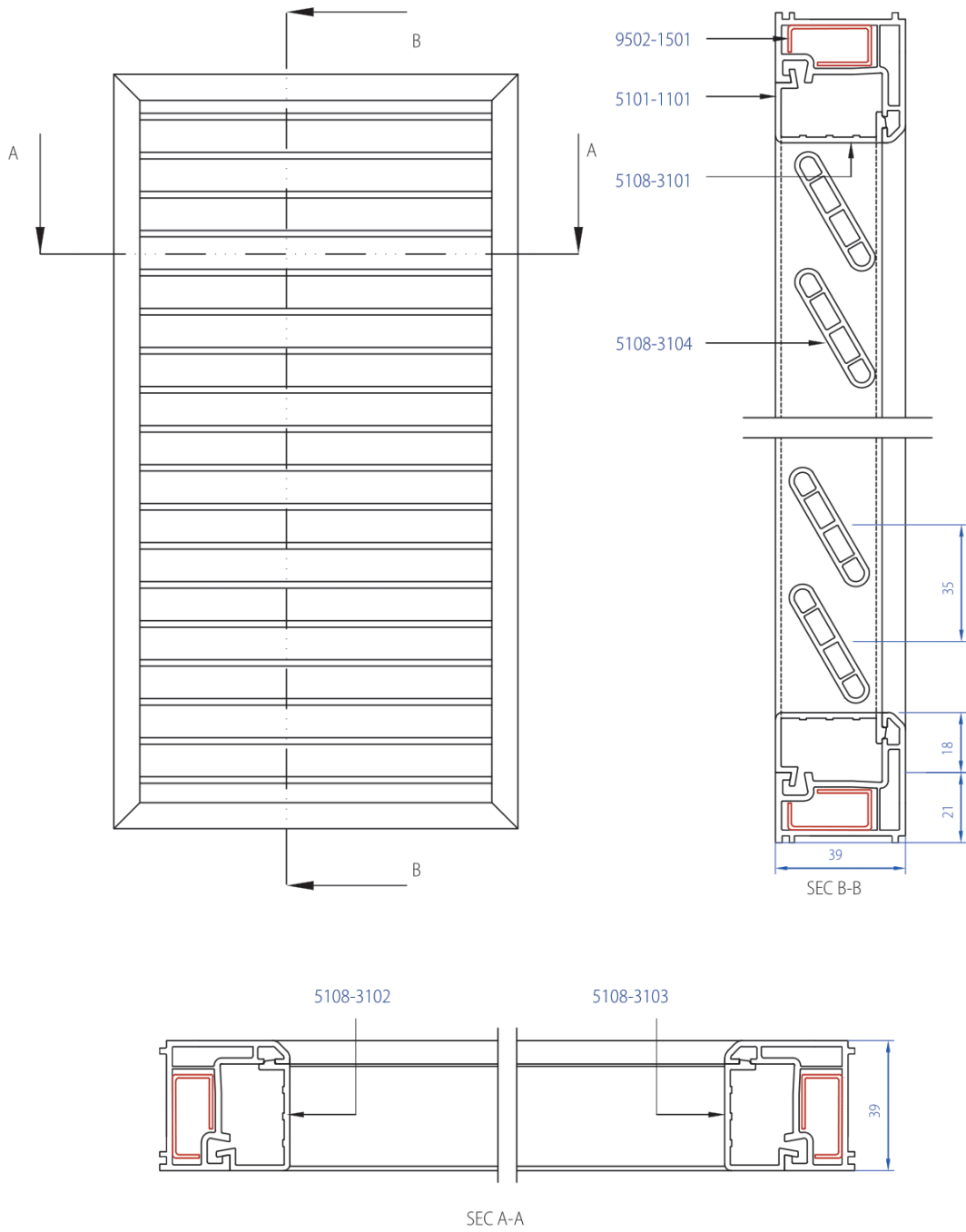

# FIXED LOUVER SECTIONAL DRAWING



**SELECTA**  
**SLIDING**

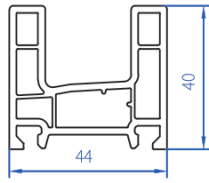

2T Frame  
4104-3101

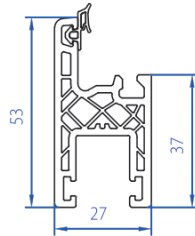

Eco Sliding Sash  
4105-1101

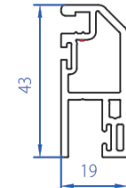

Eco Fly mesh Sash  
4105-3102

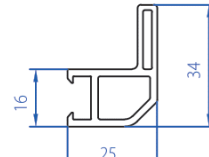

Clip On Frame  
4104-3102

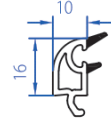

Eco Sliding Bead  
4107-4101

# PROFILES

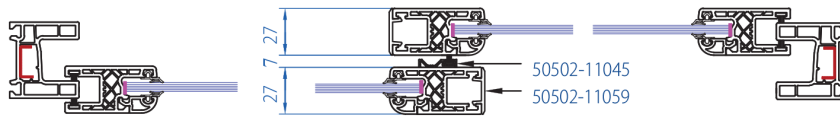
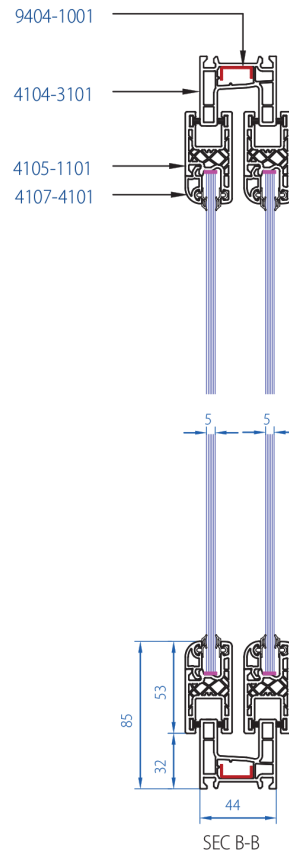
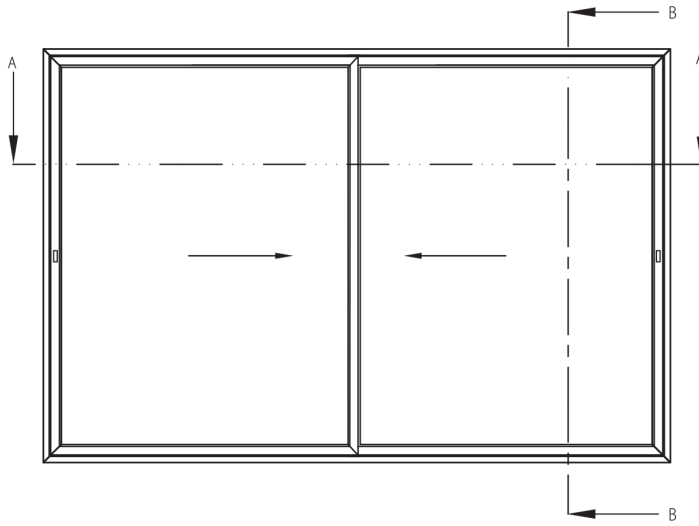

SEC A-A

# 2 TRACK 2 PANEL WINDOW SECTIONAL DRAWING

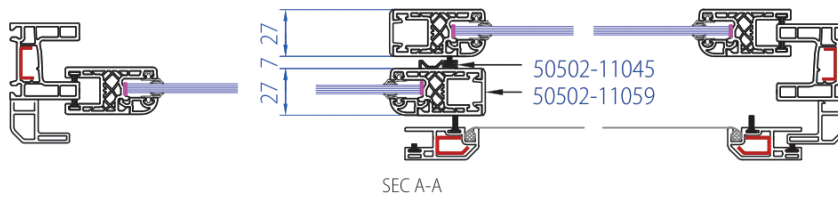
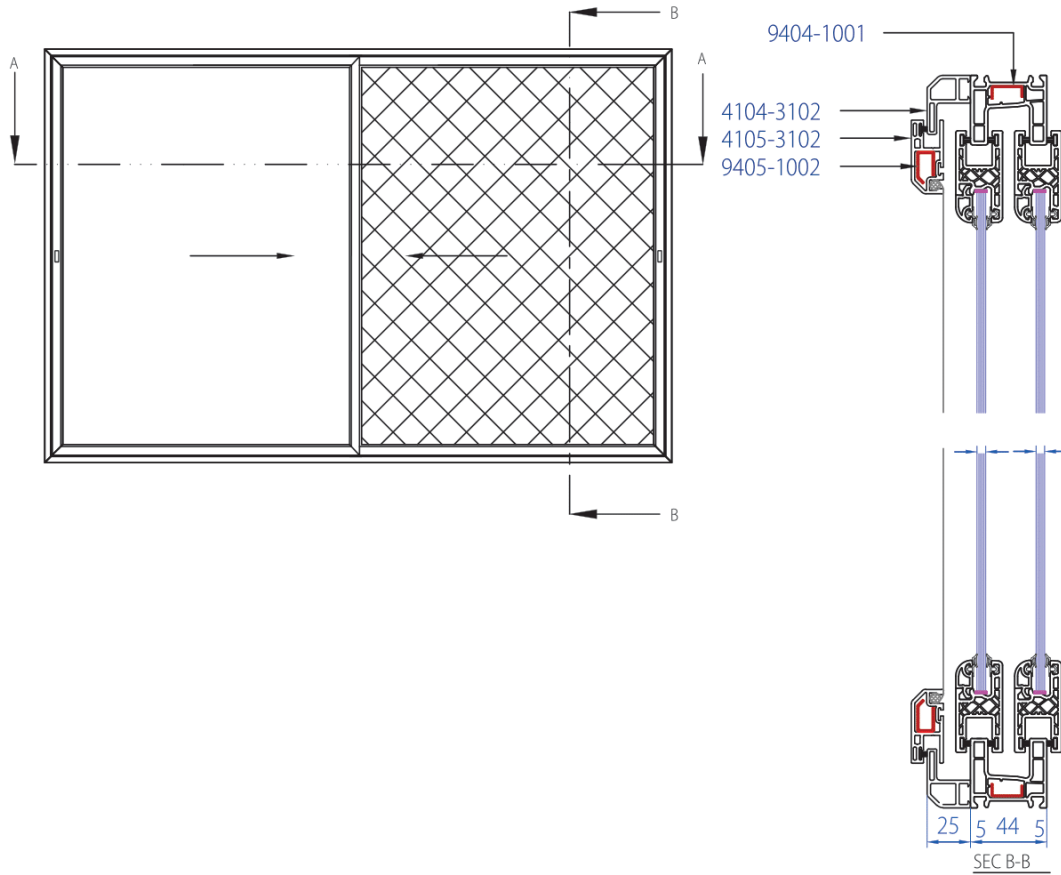

## 2 TRACK 2 PANEL WINDOW WITH MESH SECTIONAL DRAWING

# OTHER PROFILES

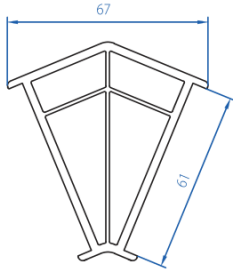

135° Corner Coupling  
2108-3110

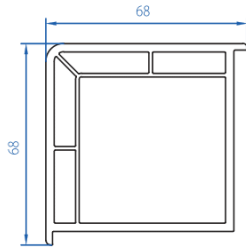

90° Corner Coupling  
2108-3101

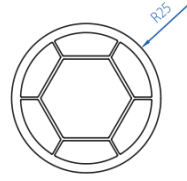

Bay Pole  
2108-3103

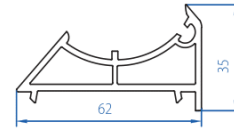

Bay Pole Adaptor  
2108-3104



Mini Coupling  
2108-3108

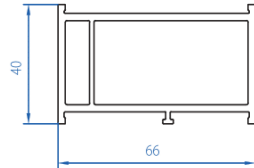

Coupling/ Extension Profile  
2108-3106

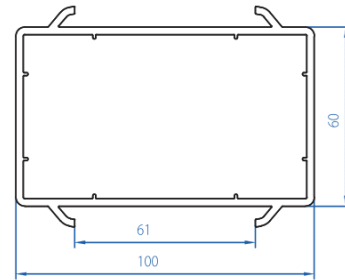

Heavy Duty Coupling  
2108-3109

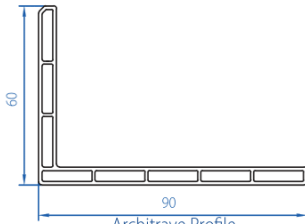

Architrave Profile  
2108-3102

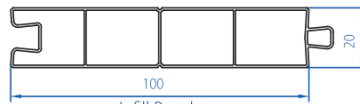

Infill Panel  
2108-3111

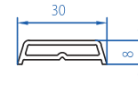

Georgian bar  
2108-3105

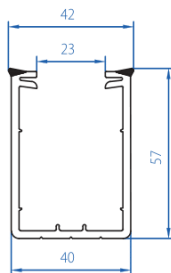

Stiffener Profile  
2108-4107

## ANCILLARY PROFILES

**PRIMA CASEMENT**

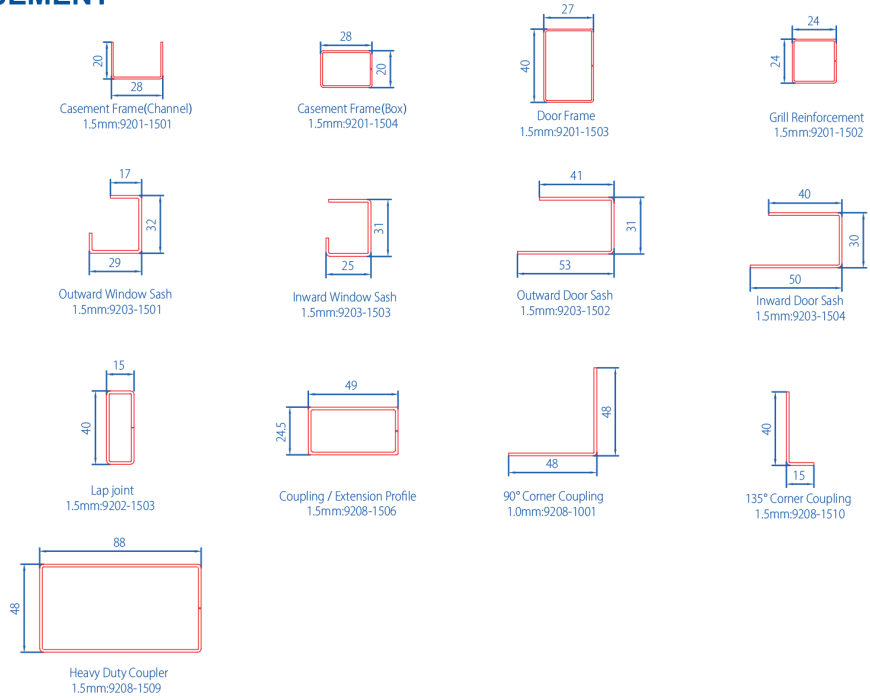

**PRIMA SLIDING**

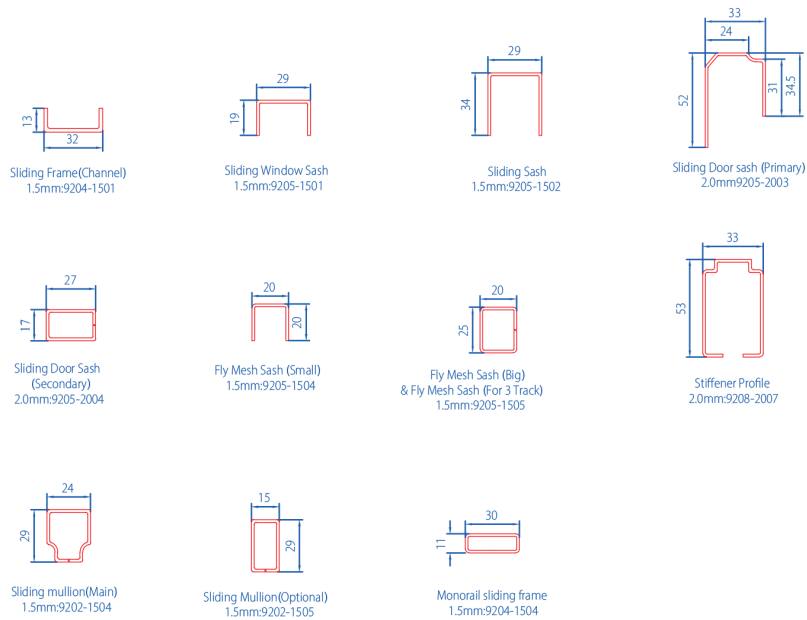

Note : The thickness of the reinforcements are indicative only and need to be optimized based on site and window conditions

**REINFORCEMENTS**



## SUPRA SLIDING

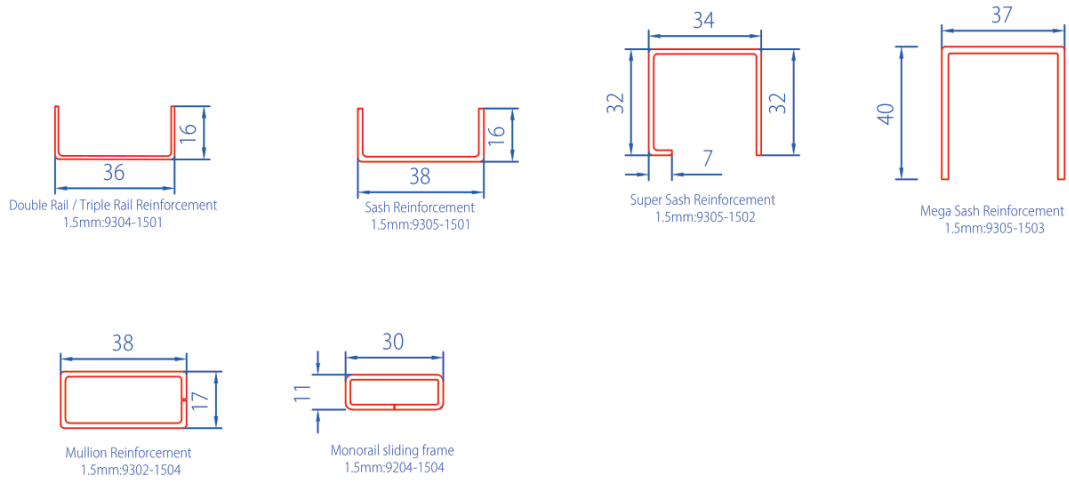

## SELECTA CASEMENT

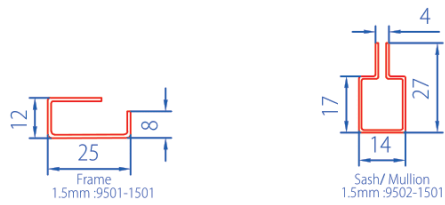

## SELECTA SLIDING



Note : The thickness of the reinforcements are indicative only and need to be optimized based on site and window conditions

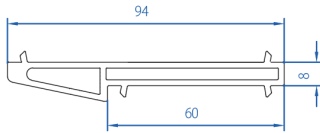

Casement-Sliding Profile  
Coupler (PRIMA)  
50502-11039

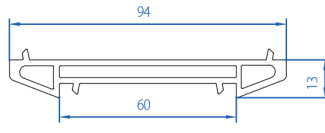

Casement-Sliding Profile  
Middle Coupler (PRIMA)  
50502-11040

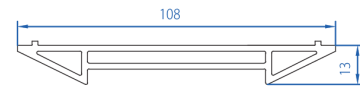

3-Track Coupler (PRIMA)  
50502-11057

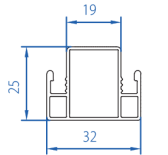

Fly Mesh Sash (Small)  
Mullion  
50502-11037

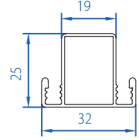

Fly Mesh Sash (Big)  
Mullion  
50502-11058

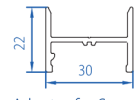

Adaptor for Screen  
Sash-2.5T  
50502-11048

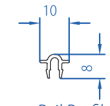

Rail Profile  
50502-11011

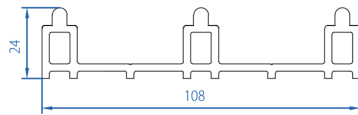

3-Track Low Threshold (PRIMA)  
50502-11047

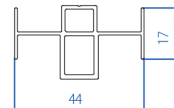

Inline sash Adaptor  
(PRIMA)  
50502-11076

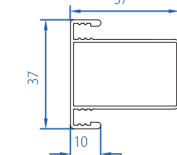

Super Screen Sash Mullion-3T  
50502-11077

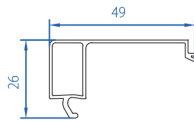

Fixed Louver Clip (PRIMA)  
50502-11038

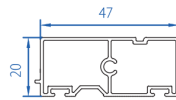

Casement door sash Infill (PRIMA)  
50502-11070

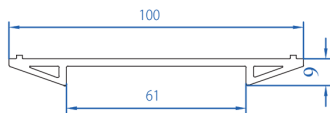

Casement-Sliding Profile  
Coupler (SUPRA)  
50502-11063

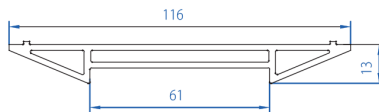

Casement-Sliding Profile  
Middle Coupler (SUPRA)  
50502-11064

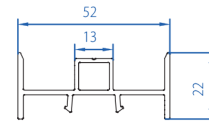

Inline sash adaptor  
(SUPRA)  
50502-11065

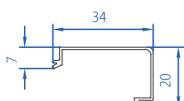

Louvre Clip (SELECTA)  
50502-11056



Lap Strip (SELECTA)  
50502-11045



Sash Cover (SELECTA)  
50502-11059



Frame Coupler (SELECTA)  
50502-11061

# ALUMINIUM PROFILES





Manufacturing Facility:  
Sr.No. 10-6 Near Kalubai  
Mandir, Pisoli Rd, Behind  
Dharmavat Petrol Pump,  
Dhawade Mala, Pune,  
Maharashtra 411028

